

DESIGN I

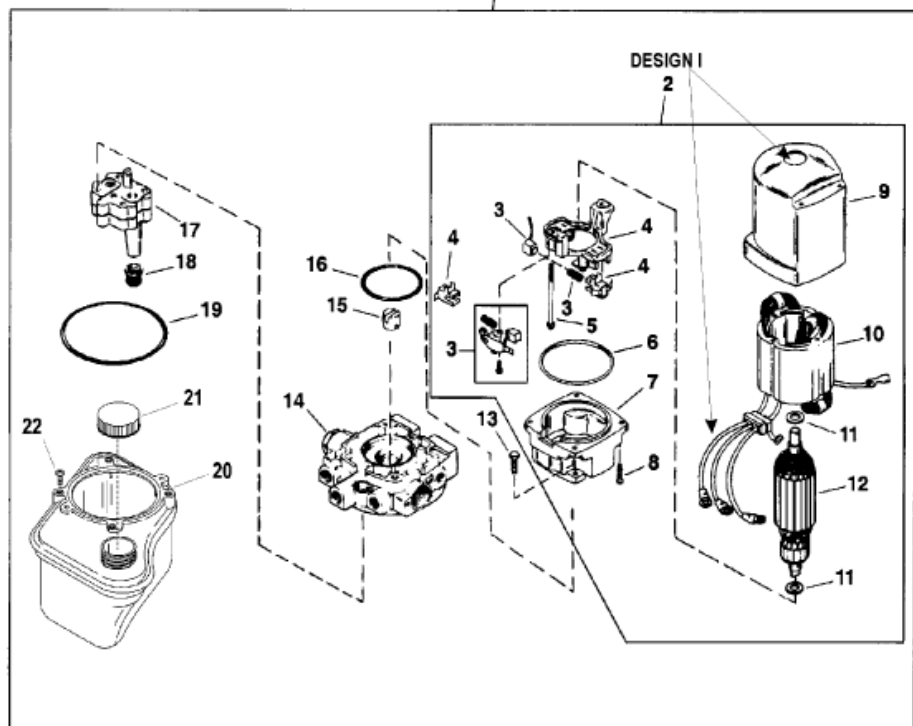

- 23
VALVE KIT-RELIEF
(UP PRESSURE)
- 24
VALVE KIT-RELIEF
(DOWN PRESSURE)
- 25
VALVE KIT
(THERMAL RELIEF)
- 26
REPAIR KIT
(OVERHAUL)

Parts List

Ref	Class	Part	Description	Qty	Comment	Footnote
1		14336A20	PUMP/MOTOR ASSEMBLY	1	(TOP MT RESERVOIR)(DESIGN I	
2		17649T	MOTOR ASSEMBLY (Complete)	1	(DESIGN I -Small Manufacturing D	
3		17631A 1	BRUSH KIT	1		
4		17633	HOLDER KIT, Brush	1		
5	10	17621	SCREW	1		
6	25	17625	O-RING	1		
7		17632T	END CAP ASSEMBLY	1		
8	10	17626	SCREW	4		
9		17622	COVER ASSEMBLY, With Bear	1		
10		17624	FIELD AND FRAME ASSEMBL	1		
11	12	17653	WASHER, Thrust	2		
12		17623	ARMATURE	1		
13	10	823444	SCREW	2		
14		808728T	ADAPTER ASSEMBLY	1		
15		803852	COUPLING	1		
16	25	89498	O-RING	1	(Motor End)	
17		18529	PUMP ASSEMBLY	1	(Includes Screws)	
18	35	89496	FILTER	2		
19	25	17645	O-RING	1	(Reservoir End)	
20		883166A 2	RESERVOIR KIT	1	(With Filters-Ref 18 and O-Ring Re	
21	36	861597	CAP, Oil Reservoir	1		
22	10	883167	SCREW, (#8-32)	4		
23		812498A 1	VALVE KIT, Relief (Up Pressure)	1		
24		812499A 1	VALVE KIT, Relief (Down Pressure)	1		
25		95353A 1	VALVE KIT, Relief (Thermal Relief)	1		
26		18545A 1	REPAIR KIT, Overhaul	1		